

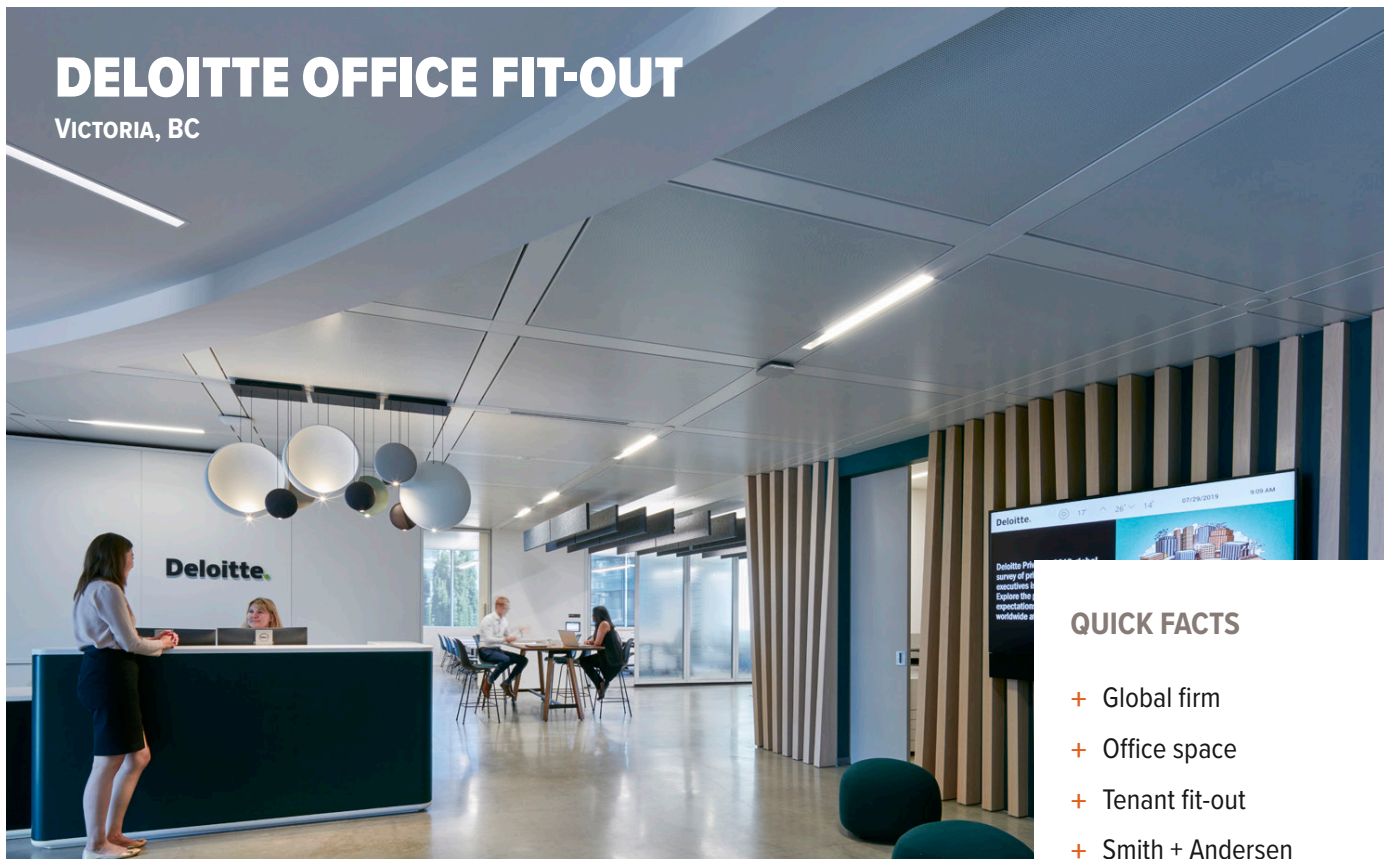

DELOITTE OFFICE FIT-OUT

VICTORIA, BC



QUICK FACTS

- + Global firm
- + Office space
- + Tenant fit-out
- + Smith + Andersen
Electrical and
Communications

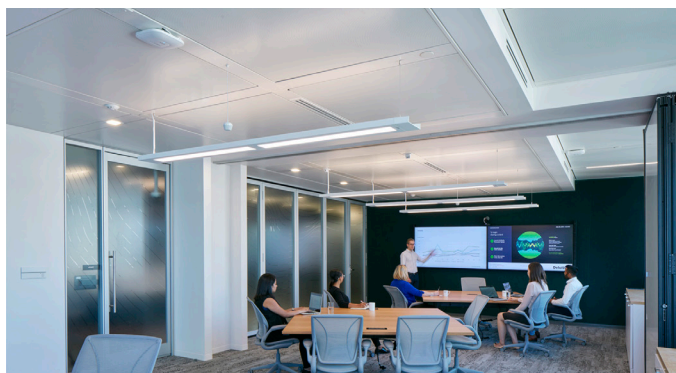
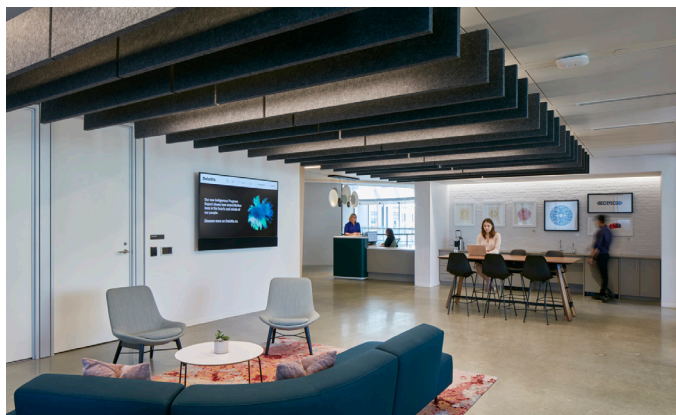

PHOTO CREDIT: JAMES BRITAIN PHOTOGRAPHY



DELOITTE OFFICE FIT-OUT

ABOUT THIS PROJECT

- + Full-floor fit-out of Deloitte's office space within a new office tower.
- + Included the design of electrical power systems, speciality lighting, and lighting controls.
- + Electrical design included horizontal cabling systems design.
- + Required in-depth design coordination to meet extensive and specific client requirements while adhering to local building codes, standards, and landlord requirements.
- + Designed speciality lighting control systems to integrate with audio-visual systems.
- + Designed the layout of a server room in order to suit client standards and network requirements.
- + Collaborated with the design team—particularly with the mechanical design consultants—to establish placement of all ceiling devices.
- + Coordinated equipment within the ceiling plenum with radiant ceiling panels in order to avoid potential interference, and support smooth operation of the radiant panel system.

LOCATION
Victoria, BC

SMITH + ANDERSEN
SERVICES PROVIDED
Electrical, Lighting,
Communications

KEY TEAM MEMBERS
Giacomini SpA

COMPLETION YEAR
2019

HOT BUTTONS

OFFICE SPACES

FIT-UP

ELECTRICAL

COMMUNICATIONS

TENANT

AUDIO-VISUAL

OFFICE TOWER

LIGHTING DESIGN

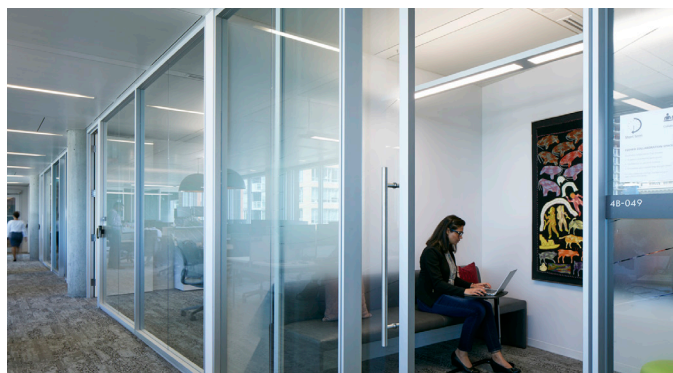

PHOTO CREDIT: JAMES BRITAIN PHOTOGRAPHY